

Technical data sheet



Product features

Model	SAP Code	00021100
FTHC 30 ED + KD 30 T	A group of articles - web	Grills and grill plates

- Top type: Smooth
- Griddle dimensions [mm x mm]: 320 x 480 + 320 x 380
- Griddle thickness [mm]: 10.00
- Container for liquid fat: Yes
- Independent heating zones: Separate control for top and bottom plate
- Maximum device temperature [°C]: 300
- Surface finish: durable chrome
- Removable rim: No

SAP Code	00021100	Power electric [kW]	6.000
Net Width [mm]	330	Loading	2x 230 V / 1N - 50 Hz
Net Depth [mm]	660	Griddle dimensions [mm x mm]	320 x 480 + 320 x 380
Net Height [mm]	450	Top type	Smooth
Net Weight [kg]	40.00		

Technical data sheet



Technical drawing

Model	SAP Code	00021100
FTHC 30 ED + KD 30 T	A group of articles - web	Grills and grill plates

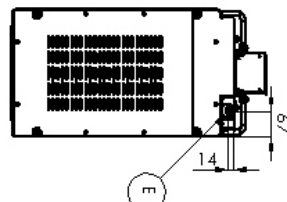
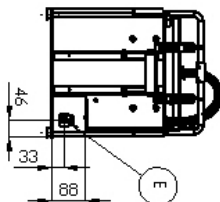
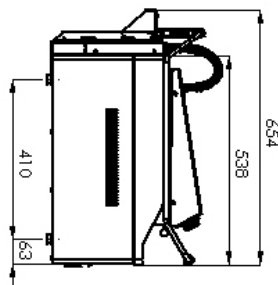
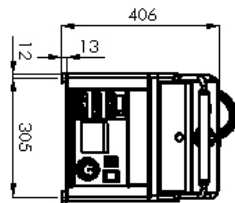

Technical data sheet



Technical parameters

Model	SAP Code	00021100
FTHC 30 ED + KD 30 T	A group of articles - web	Grills and grill plates

1. SAP Code:

00021100

2. Article group:

RF-Grills

3. Net Width [mm]:

330

4. Net Depth [mm]:

660

5. Net Height [mm]:

450

6. Net Weight [kg]:

40.00

7. Gross Width [mm]:

705

8. Gross depth [mm]:

395

9. Gross Height [mm]:

482

10. Gross Weight [kg]:

44.00

11. Device type:

Electric unit

12. Construction type of device:

Table top

13. Power electric [kW]:

6.000

14. Loading:

2x 230 V / 1N - 50 Hz

15. Protection of controls:

IPX4

16. Device color:

Stainless steel

17. Material:

AISI 430

18. Indicators:

operation and warm-up

19. Surface finish:

durable chrome

20. Maximum device temperature [°C]:

300

21. Minimum device temperature [°C]:

50

22. Griddle dimensions [mm x mm]:

320 x 480 + 320 x 380

23. Griddle thickness [mm]:

10.00

24. Container for liquid fat:

Yes

25. Independent heating zones:

Separate control for top and bottom plate

26. Removable rim:

No

27. Uniform heating:

Yes

28. Top type:

Smooth